



70 PARKING  
SPACES AVAILABLE

AVAILABLE

3,213 SF FITNESS SPACE AVAILABLE

## DEERFIELD SHOPPER'S COURT

636-660 DEERFIELD RD, DEERFIELD, IL  
**FOR LEASE**



CONTACT: HANNAH PERL [hperl@metrocre.com](mailto:hperl@metrocre.com) 847.849.1026 // JONATHAN HYMAN [jhyman@metrocre.com](mailto:jhyman@metrocre.com) 224.365.8144



## PROPERTY HIGHLIGHTS

- 3,213 SF Fitness Space Available
- Located near the Main intersection of Deerfield Rd & Waukegan in Downtown Deerfield
- Abundant Parking Available

## DEMOGRAPHICS

	1 MILE	3 MILES	5 MILES
TOTAL POPULATION	11,988	61,962	144,739
DAYTIME POPULATION	13,400	119,668	241,578
HOUSEHOLDS	4,707	24,427	56,819
AVG HH INCOME	\$216,634	\$205,756	\$194,266

## TRAFFIC COUNTS

DEERFIELD RD	20K VPD
WAUKEGAN RD	22K VPD

## AREA TENANTS INCLUDE

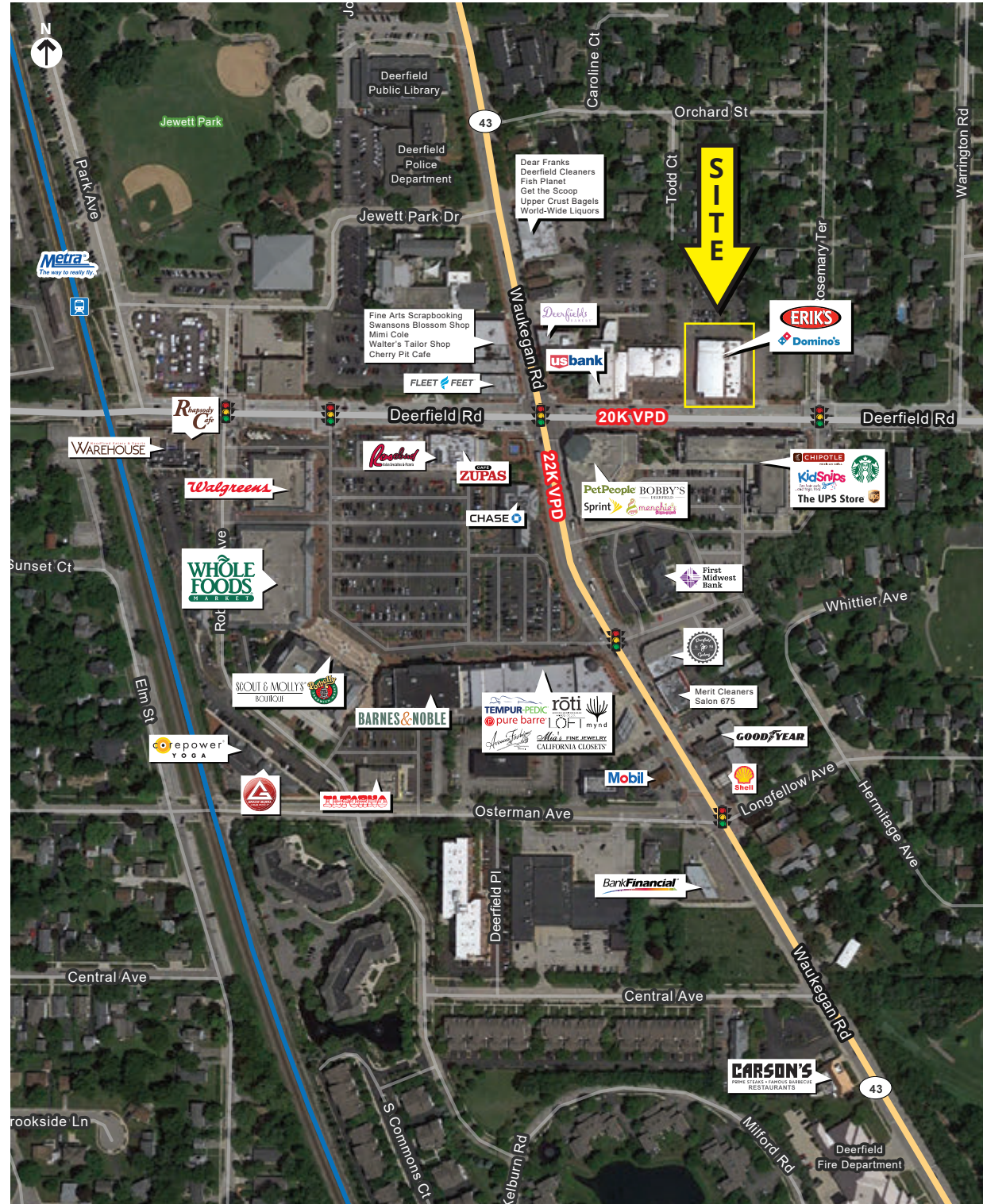



# DEERFIELD SHOPPER'S COURT

636-660 DEERFIELD RD, DEERFIELD, IL

FOR LEASE

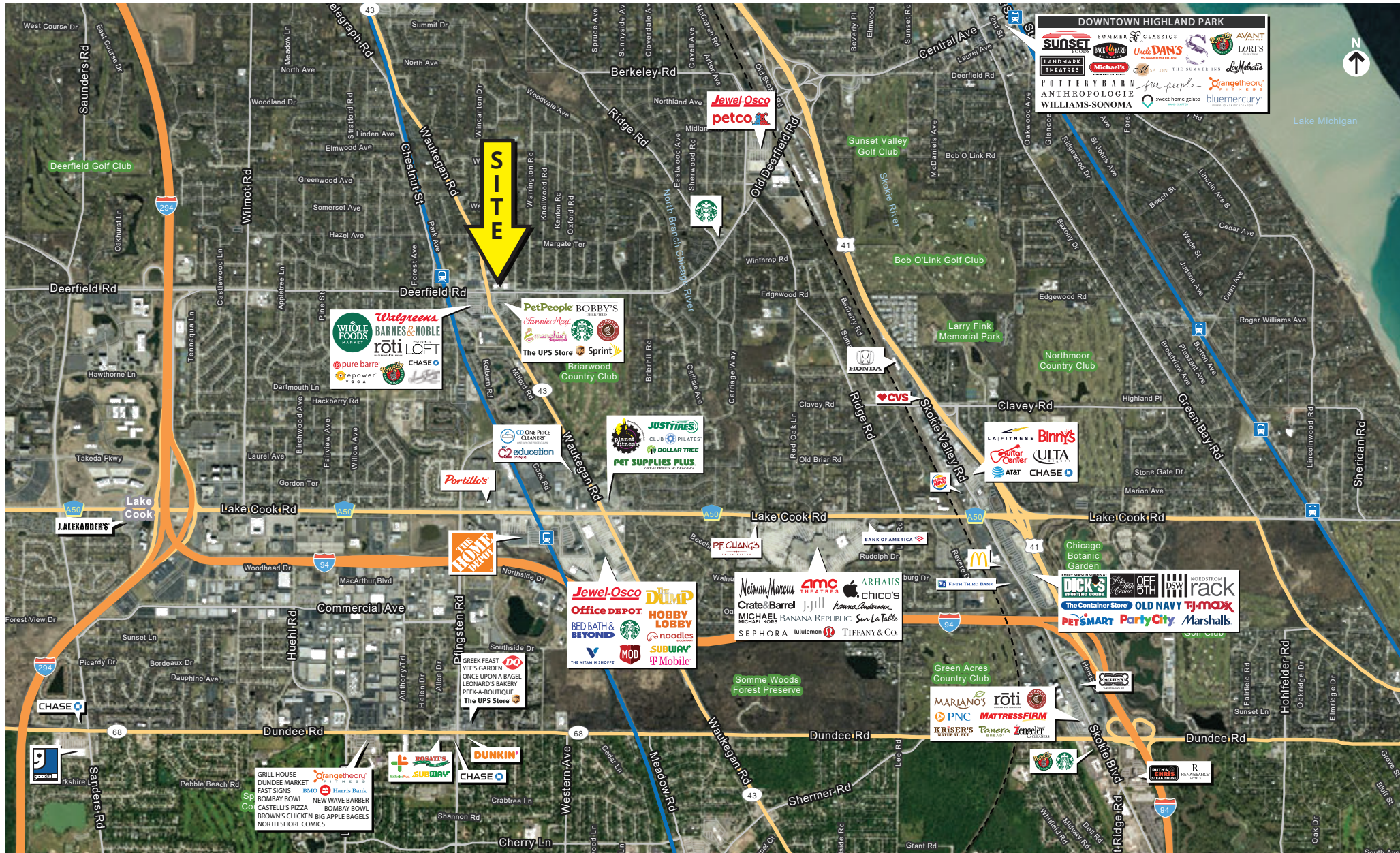

CONTACT INFORMATION:

**HANNAH PERL**  
 hperl@metrocre.com  
 847.849.1026

**JONATHAN HYMAN**  
 jhyman@metrocre.com  
 224.365.8144

1332 N Halsted St., Ste 306  
 Chicago, Illinois 60642  
 www.MetroCRE.com





# DEERFIELD SHOPPER'S COURT

636-660 DEERFIELD RD, DEERFIELD, IL

FOR LEASE



CLICK [HERE](#)  
OR SCAN FOR  
VIRTUAL TOUR  
(3,213 SF)

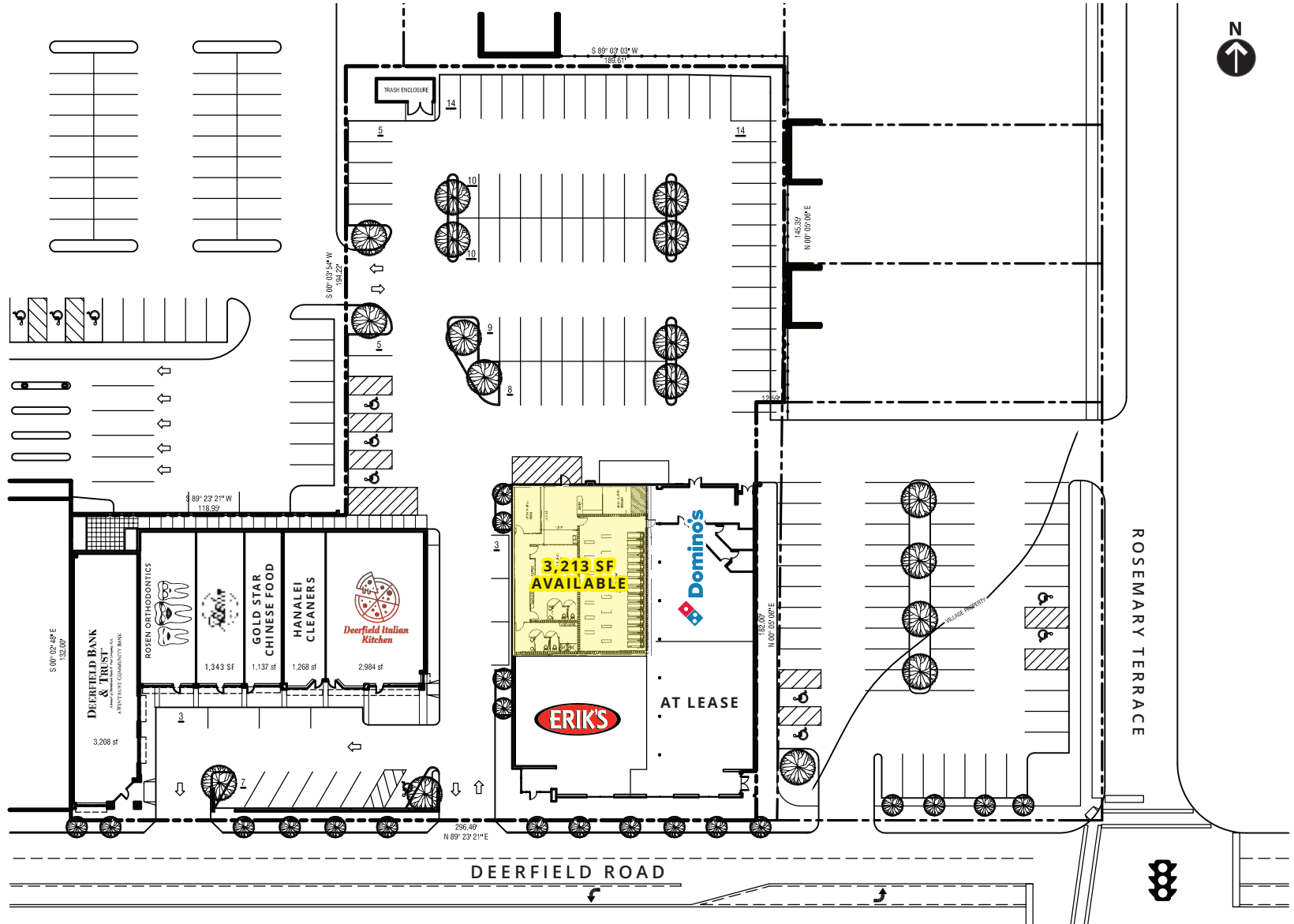

CONTACT  
INFORMATION:

**HANNAH PERL**  
hperl@metrocre.com  
847.849.1026

**JONATHAN HYMAN**  
jhyman@metrocre.com  
224.365.8144

1332 N Halsted St., Ste 306  
Chicago, Illinois 60642  
www.MetroCRE.com

