

North Side

HIGHWAY VISIBLE • DENSELY POPULATED

2367 W LOGAN BLVD
CHICAGO, IL

SPACE AVAILABLE FOR LEASE
REDEVELOPMENT OPPORTUNITY



Property highlights



- 51,777 Sq Ft Building on 1.99 Acres
- Redevelopment Possibility
- Tremendous Highway Visibility from Kennedy Expressway (I-90/94), the Direct route from Downtown to O'Hare
- Affluent Trade Area with >\$190K Household Income within 1 Mile
- Elston Retail Corridor among the busiest in Chicago; featuring Target, Home Depot, HomeGoods, Ross, Burlington, PetSmart & Costco

Demographics

	½ MILE	1 MILE	2 MILES
TOTAL POPULATION	9,897	54,774	253,222
DAYTIME POPULATION	6,592	25,705	123,819
HOUSEHOLDS	4,764	25,339	115,082
AVG HH INCOME	\$164,209	\$192,641	\$191,435

Traffic Counts

WESTERN AVE	15,937 VPD
ELSTON AVE	9,831 VPD
LOGAN BLVD	7,817 VPD
I-90/94 (KENNEDY)	281,293 VPD

Walk Score

89 WALK SCORE
very walkable //
// most errands can be accomplished on foot

63 TRANSIT SCORE
good transit //
// many nearby public transportation options

88 BIKE SCORE
very bikeable //
// biking is convenient for most trips

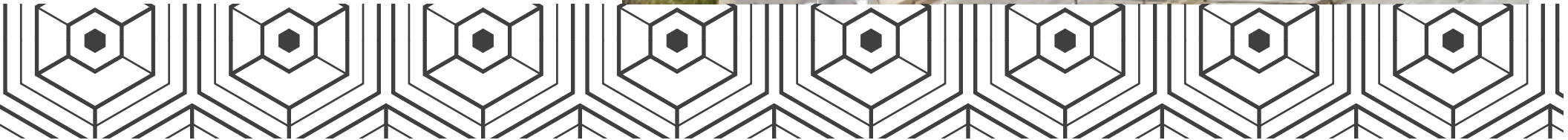

Bucktown, Chicago



Bucktown, Chicago

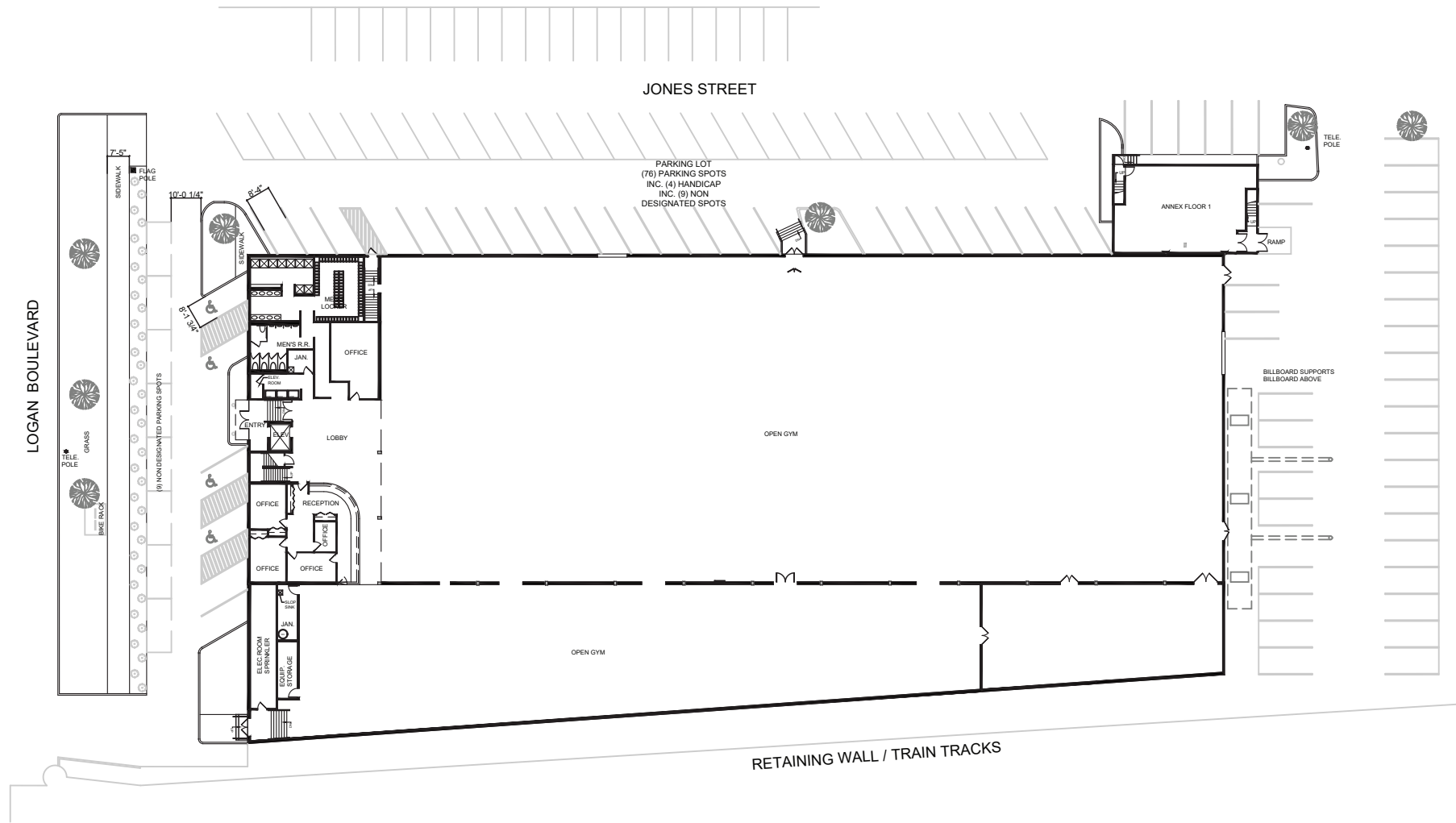

BUILDING: 51,777 SQ FT

LAND: 1.99 ACRES



Leasing Contacts

STEVEN BAER

SBAER@METROCRE.COM
847.412.9898

GARY GREENFIELD

GGREENFIELD@METROCRE.COM
847.412.9898



WWW.METROCRE.COM

