



800 - 3,351 SF RETAIL SPACE AVAILABLE

ELMHURST CENTER

624 NORTH YORK STREET, ELMHURST, IL

FOR LEASE

CONTACT: HANNAH PERL hperl@metrocre.com 847.840.4300 // JONATHAN HYMAN jhyman@metrocre.com 224.627.3812

METRO
COMMERCIAL REAL ESTATE

PROPERTY HIGHLIGHTS

- 800 - 3,351 SF outlot space available
- Join co-tenants Starbucks, and Hand & Stone Spa
- Shadow anchored by Mariano's and LA Fitness
- Densely populated high income trade market

DEMOGRAPHICS

	1 MILE	3 MILES	5 MILES
TOTAL POPULATION	10,338	106,592	283,291
DAYTIME POPULATION	11,241	97,258	288,793
HOUSEHOLDS	3,667	36,882	100,067
AVG HH INCOME	\$146,157	\$125,111	\$106,671

TRAFFIC COUNTS

N YORK ST	24,917
I-290 EAST BOUND	66,920
I-290 WEST BOUND	72,362
I-294 SOUTH BOUND	83,231

AREA TENANTS INCLUDE

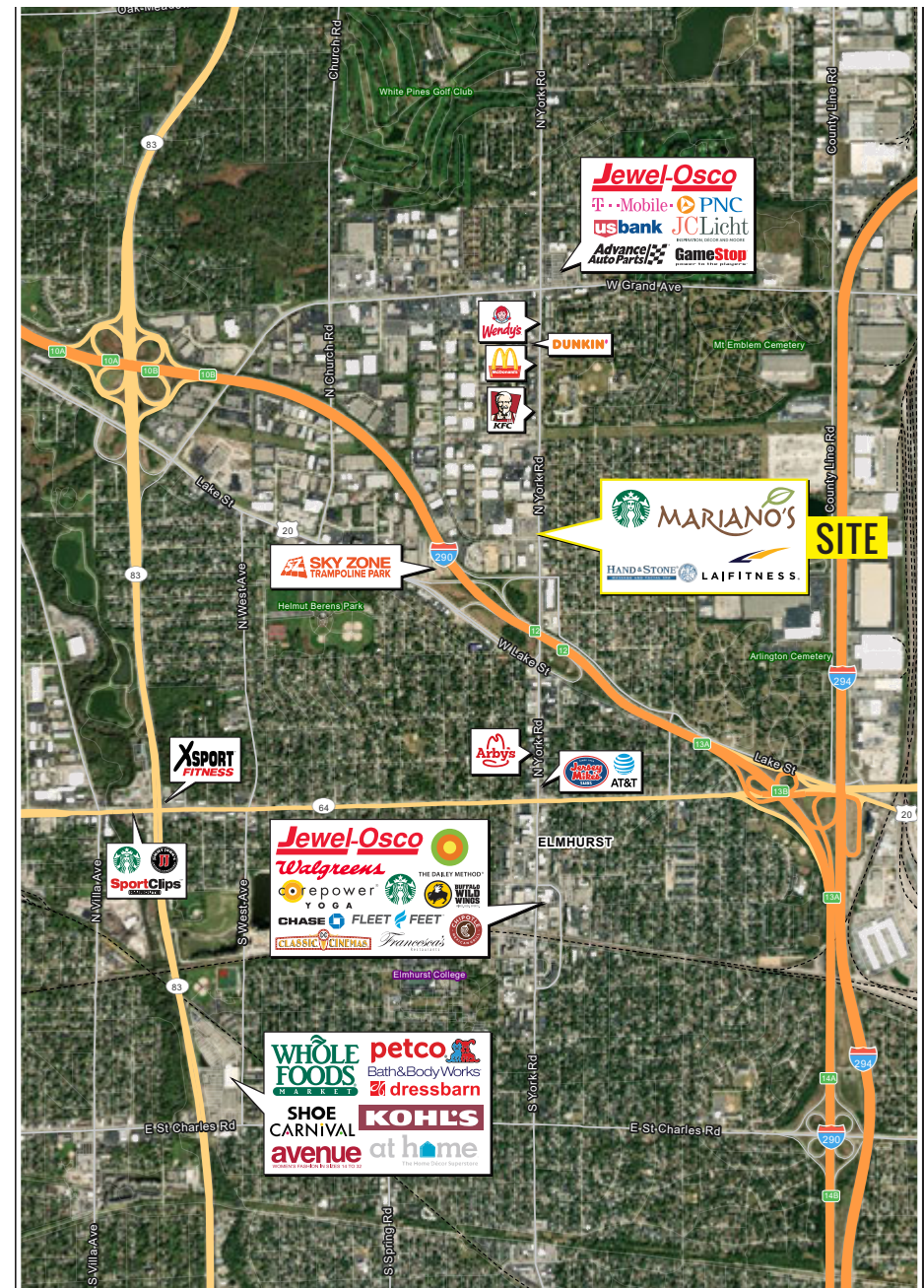

ELMHURST CENTER

624 NORTH YORK STREET, ELMHURST, IL

FOR LEASE



#	TENANT	SF
620	LA FITNESS	37,000
624A	Starbucks	1,850
624B	AVAILABLE	2,200
624C	AVAILABLE	1,151
624D	Hand & Stone Massage	2,562

CONTACT
INFORMATION:

HANNAH PERL
hperl@metrocre.com
847.840.4300

JONATHAN HYMAN
jhyman@metrocre.com
224.627.3812

56 Skokie Valley Road
Highland Park, Illinois 60035
www.MetroCRE.com





CLICK [HERE](#)
OR SCAN FOR
VIRTUAL TOUR
1,151 SF



CLICK [HERE](#)
OR SCAN FOR
VIRTUAL TOUR
2,200 SF

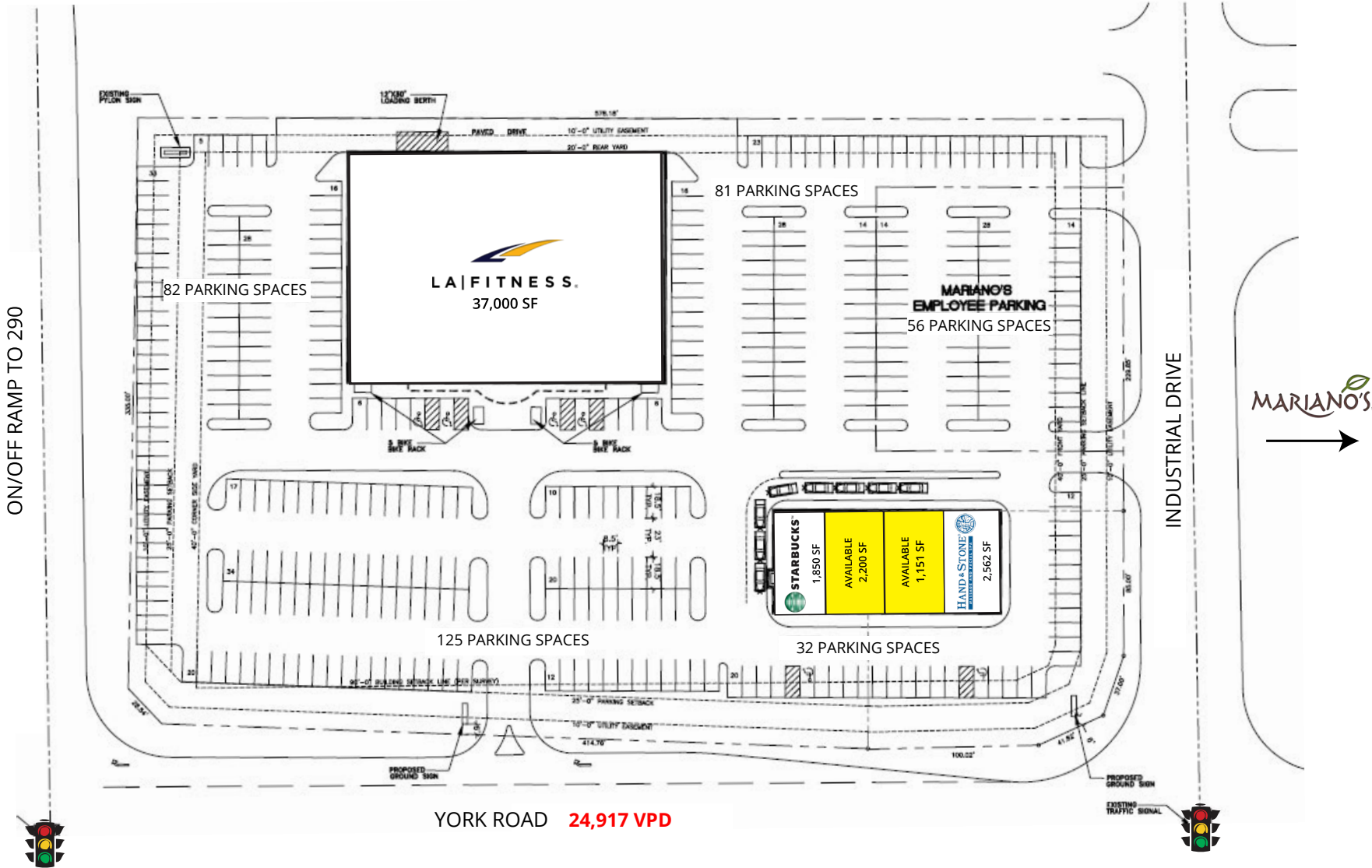

CONTACT
INFORMATION:

HANNAH PERL
hperl@metrocre.com
847.840.4300

JONATHAN HYMAN
jhyman@metrocre.com
224.627.3812

56 Skokie Valley Road
Highland Park, Illinois 60035
www.MetroCRE.com

